

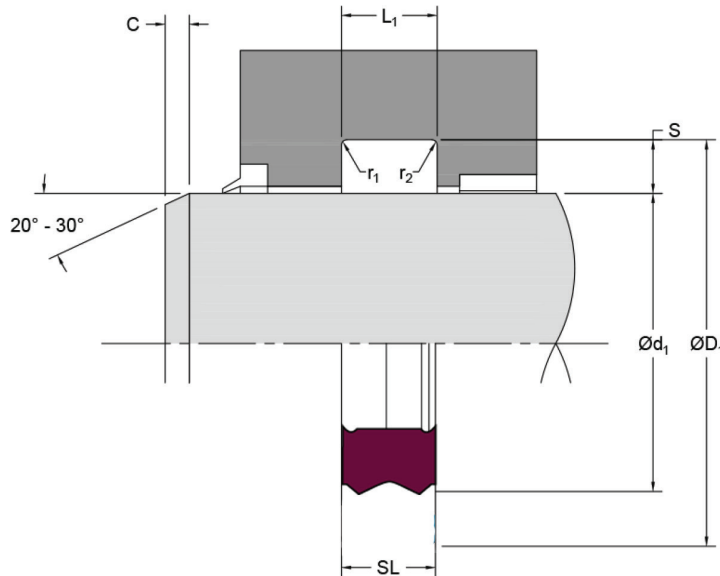

HR4E



Technical Details Metric Inch

Operating conditions		
Maximum speed	0.1 m/sec	0.3 ft/sec
Temperature range	-30°C + 80°C	-22°F + 76°F
Maximum pressure	350 Bar	5000 p.s.i

Surface roughness

	µmRa	µmRt	µinCLA	µinRMS
Dynamic sealing surface Ød ₁	0.1 - 0.4	4 max	4 - 16	5 - 18
Static sealing face ØD ₁	1.6 max	10 max	63 max	70 max
Static Housing faces L ₁	3.2 max	16 max	125 max	140 max

Chamfers & Radii

Seal diameter ≤ S mm	5.2
Min chamfer C mm	2.4
Max fillet rad r ₁ mm	0.4

Tolerances

Ød ₁	ØD ₁	ØD ₂	L ₁ mm
f8	H10	H8	+0.3 - 0

DESIGN

HR4E is a rotary pressure seal that is designed specifically for use in hydraulic swivel joints.

Manufactured from high performance polyurethane, it provides ease of installation and has excellent sealing characteristics.

FEATURES

- Long life
- Easy installation
- Comes in a wide range of sizes

MATERIAL

Seal design comes in a variety of materials and sizes. For more information, please refer to MSDS datasheet.

APPLICATIONS

Light to medium duty applications